

LA40

PART NO

AGA-ARM-100-000

COMPLIES WITH

AS1170.0, AS1170.1, AS4100, AS4673, AS4991

With six points of articulation and smart spring technology, the LA40 achieves a full range of horizontal and vertical movement. Apart from the obvious benefits to hand safety by reducing finger exposure to pinch points, the LA40 offers positive improvements to operator overall wellbeing through reduced manual handling. Impressive efficiency gains have been seen as an added bonus, stemming from the improvements offered by the LA40.

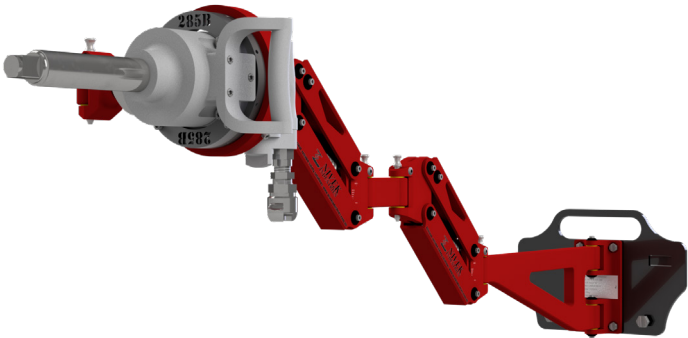

SPECIFICATIONS	
Tare weight (kg/lbs)	20 / 45
Safe Working Load (kg/lbs)	40 / 89
Material	Aluminum frame with stainless steel pins
Assembly	Each section is joined together via a quick release pin allowing for quick assembly and disassembly
Degrees of movement	Six points of articulation, smart spring system, and a swivel head, provides complete freedom of movement.
Adjustment	Each spring section has a spring tension adjustment bolt allowing the operator to calibrate the LA40 spring tension to suit the tool being utilised.
Mounting	Using the mounting bolt hole pattern (see dimensions) the LA40 can be mounted to any surface. A TED mounting plate is provided as standard with every LA40.
Tool Mounting	Each LA40 is fitted with a Quick Release tool mounting system. Operators select the appropriate bracket from the library, bolt it to a spigot (if required) and insert it into the quick release mechanism.



DIMENSIONS (MM/INCH)

Length (L1)	1,760 / 69.3	Base Width (BW)	110 / 4.4
Length (L2)	1,630 / 64.2	Base Height (BH)	200 / 7.9
Width (W)	70 / 2.8	Mounting Hole (HW)	79.2 / 3.2
Height Range (H)	600 / 23.6	Mounting Hole (HH)	169.2 / 6.7

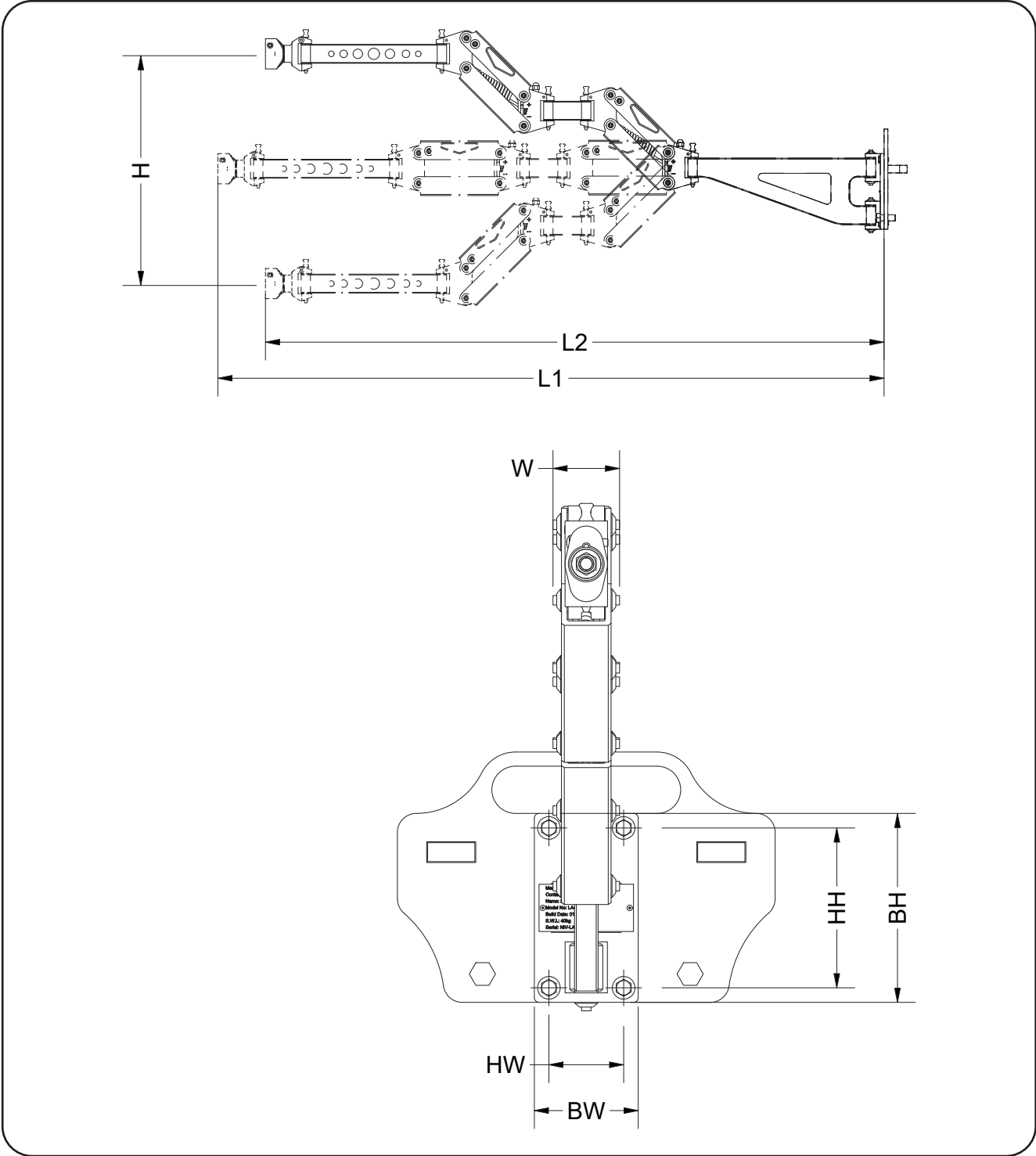

nivekindustries.com.au

sales@nivekindustries.com.au

+61 (0)400 675 531



NIVEK
INDUSTRIES
PTY LTD